城市地下空間發展：策略性地區先導研究

Pilot Study on

Underground Space Development

in Selected Strategic Urban Areas

概念設計比賽
Design Ideas Competition



土木工程拓展署
Civil Engineering and
Development Department



規劃署
Planning Department



香港大學社會科學學院
策動永續發展坊



研究背景 Study Background

研究目的 Study Aims:

- ▶ 辨識策略性地區內發展地下空間的潛力
To identify the potential for underground space developments in the selected Strategic Urban Areas
- ▶ 制定地下空間總綱圖，為未來地下空間發展作出指引
To formulate Underground Master Plans to guide the future underground space development

四個策略性地區

Four selected Strategic Urban Areas



概念設計比賽 Design Ideas Competition

比賽宗旨 Purpose of the Competition

鼓勵**青年參與**城市地下空間發展的規劃及設計

To encourage **youth participation** in the planning and design of potential urban underground space development(s)

我們的對象 Our Targets :

- ▶ 相關學科的**大專院校學生**及專業學會的**年青會員**，包括：
Tertiary students and **young members** of professional institutes in the relevant fields in Hong Kong, including:

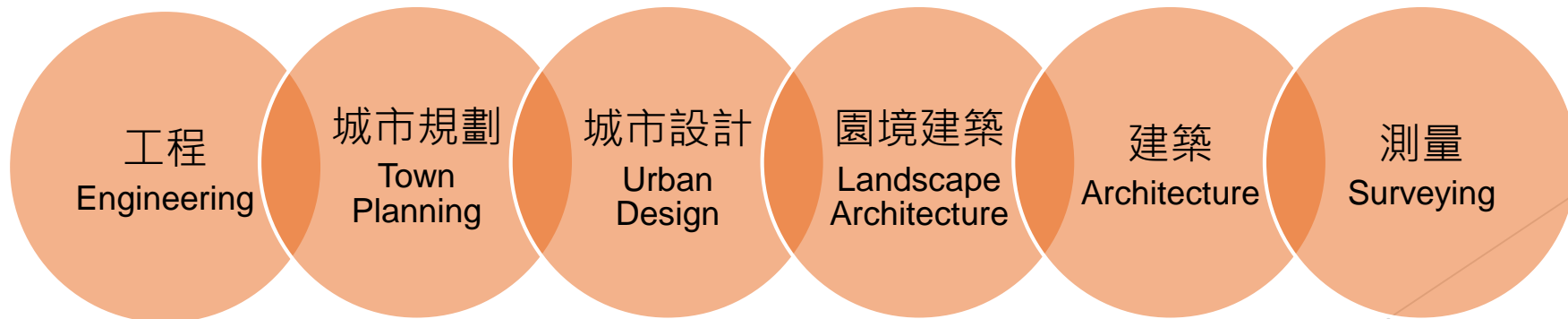

概念設計比賽 (續) Design Ideas Competition (cont.)

願景 Vision

創造連貫、互通、高質素和富有活力的地下空間網絡

To create a coherent, connected, high quality and vibrant network of underground space



加強地下行人網絡
的連接性

To enhance the
underground pedestrian
connectivity

創造吸引宜人的
公共地下領域

To create an
attractive
underground public
realm

創造空間以善用
土地資源

To create space to
optimise the land
use

範圍 Study Area

主要特色 Major Features :

- ▶ 一個主要的**旅遊、商業和娛樂中心**
A major **tourism, commercial and entertainment hub**
- ▶ 毗鄰不同目的地，包括發展中的**西九文化區及多條港鐵線的車站**
Surrounded by different destination nodes, including the **West Kowloon Cultural District being developed and MTR stations of various lines**
- ▶ 前威菲路軍營，擁有**文物古蹟及其他特色**，如廢置的防空隧道及成熟樹木，包括古樹名木
Formerly the Whitfield Barracks with **built heritage and other features** such as disused air-raid tunnels and mature trees including Old and Valuable Trees (OVTs)
- ▶ 由於公園**高於地面**，公園外圍的行人路十分繁忙
The pedestrian paths along the park perimeter are heavily used due to the **elevated topography** of the Park

尖沙咀西策略性地區內的九龍公園 Kowloon Park in Tsim Sha Tsui West SUA

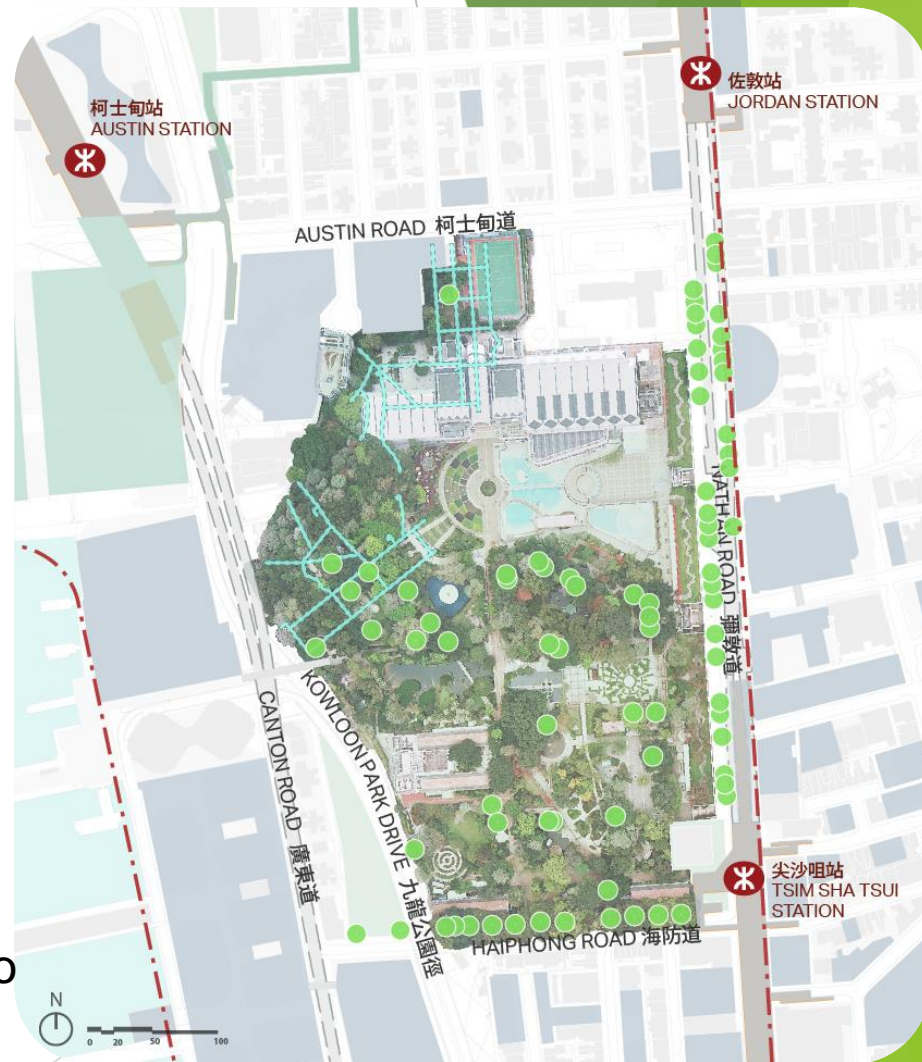

設計要求及考慮事項 Design Requirements and Considerations

- ▶ 考慮現時的法定圖則、該地區的具體發展限制，以及其他相關的研究、地方改善工程及其他進行中的相關研究

To make reference to existing statutory plan(s) and any specific development restriction imposed on the area, as well as other relevant studies, local improvement works and other relevant on-going studies

- ▶ 考慮任何現時及已規劃的主要新發展或基建項目，以避免抵觸或影響整體規劃及設計
- To take into consideration of any existing and planned major new development or infrastructure projects nearby that may be in conflict with or affect the overall planning and design

- ▶ 保存易受破壞的設施，包括公園內的文物及古樹名木

To preserve the sensitive features including built heritages and Old and Valuable Trees (OVTs) in the Park

- ▶ 活化廢置的防空隧道

To revitalise the disused air-raid tunnels

- ▶ 考慮融合地下空間發展的可能性，以優化九龍公園的設計及功能

To explore the possibility of integrating underground space development to enhance the design and functionality of the Kowloon Park



設計背景及限制可參閱
章節一及二
Refer to Chapters 1 & 2 for
design context and constraints

時間表 Schedule

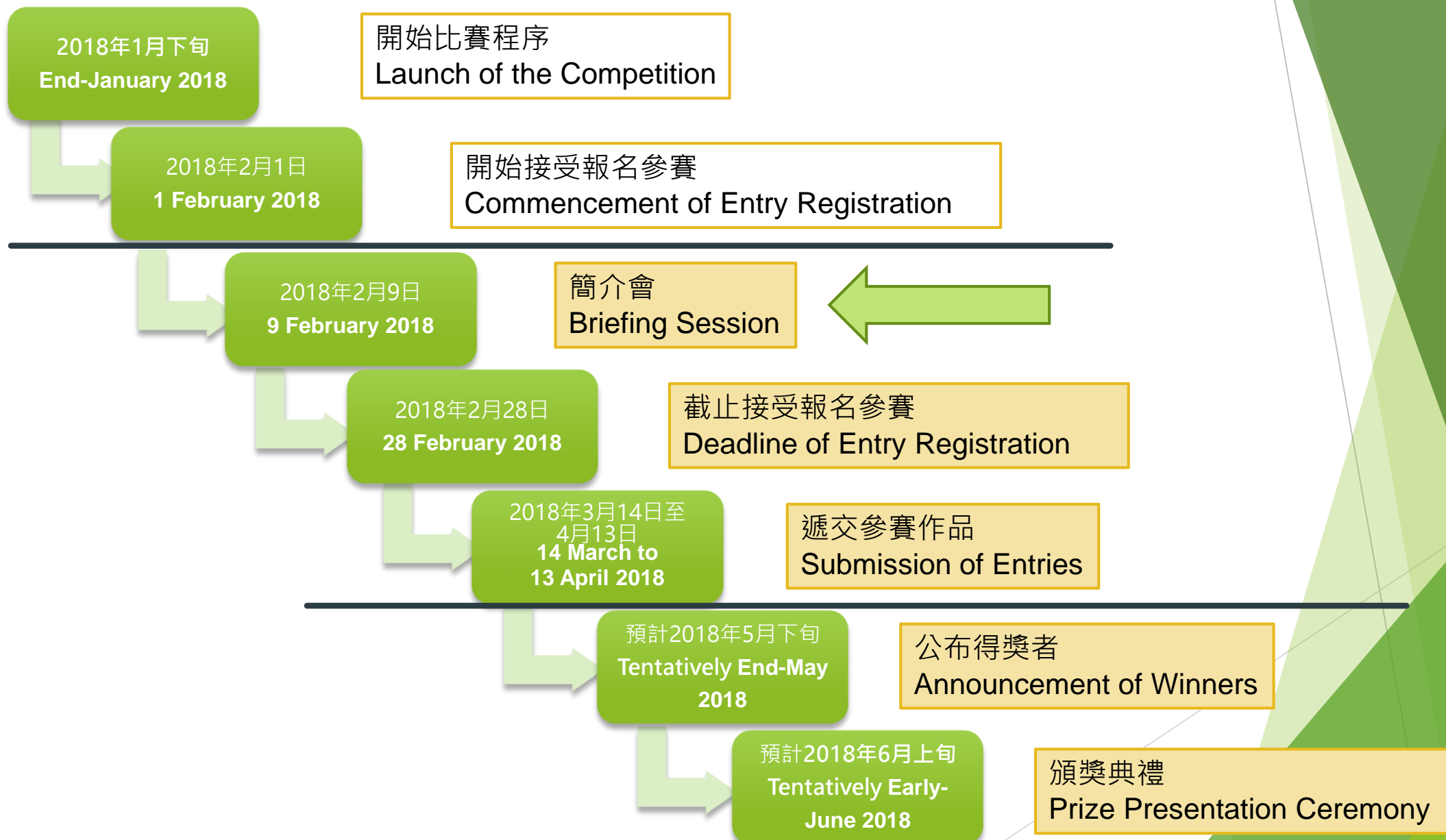

報名 Registration

- ▶ 必須預先透過電郵向統籌機構報名參賽 : info_urbanunderground@aecom.com
Must make prior registration to the Facilitator via study email: info_urbanunderground@aecom.com
- ▶ 任何未有報名的參賽作品將不獲受理
Entry without prior registration will not be accepted
- ▶ 已報名的參賽者可聯絡統籌機構索取以下資料:
Registrants of the Competition should contact the Facilitator for the information below:
 - ❖ 九龍公園的航空照片
Aerial photographs showing the top views of the Kowloon Park.
 - ❖ 尖沙咀西地下空間發展設計界限及限制圖的 CAD 及PDF版本
The CAD & PDF versions of the design boundary and constraints of Underground Space Development in Tsim Sha Tsui West.

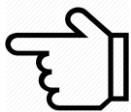

報名表格
Registration Form



截止報名日期
Deadline for Registration

28.2.2018

遞交參賽作品 Entry Submission

14.03.2018



13.04.2018

- ▶ 參賽者必須親身遞交參賽作品到統籌機構
The Entry must be delivered by hand to the Facilitator



香港大學社會科學學院策動永續發展坊
香港薄扶林香港大學百周年校園
賽馬會教學樓7樓703室
Policy for Sustainability Lab,
Faculty of Social Sciences,
Room 703, 7/F, The Jockey Club Tower,
Centennial Campus, The University of Hong Kong,
Pokfulam Road, Hong Kong

- ▶ 接收時間為星期一至星期五(公眾假期除外) · 上午10:00至中午12:00及下午2:00至5:00 ·
- ▶ Receiving hours: 10:00am - 12:00 noon and 2:00pm - 5:00pm (Monday-Friday), except public holidays
- ▶ Late Entries will not be accepted
逾期遞交將不獲受理

遞交參賽作品 (續) Entry Submission (cont.)

每份參賽作品須包括 Each Entry shall comprise:

- 1** 每份遞交的參賽作品應連同**已填妥的參賽表格** (如屬小組作品，所有隊員必須簽署) 放入一個密封的 A4 尺寸信封內，並在信封面註明「*城市地下空間發展：策略性地區先導研究 - 概念設計比賽*」
A sealed A4 size envelope marked with “*Pilot Study on Underground Space Development in Selected Strategic Urban Areas - Design Ideas Competition*” enclosing a **completed Entry Form** (in the case of a collaborative Entry, all team members are required to sign)
- 2** 參賽作品應以**光碟形式 (CD/DVD)** 遞交
A design submission made through a **CD/DVD disc**
 - ▶ 以高解像的 JPG 或 PDF 格式存檔，尺寸應可列印在不多於兩張 A1 尺寸(594 毫米 × 841 毫米) 的裱貼板上
.JPG or .PDF format panels printable at the size of two A1 (594mm x 841mm, at least 300 dpi)
 - ▶ 可包括平面圖、透視圖、構思圖、電腦影像及 / 或其他圖像，以及簡短文字註解
May include layout plan(s), perspective view(s), artist’s impression(s), sketch(es), computer image(s) and/or other drawing(s), as well as brief text annotations
- 3** 中英文各300字以內的**說明** (一併儲存在光碟內)
An **explanatory statement** in <300 words in **both** Chinese and English (to be saved in the disc too)
 - ▶ 分別列印在一張A4 紙上; 字體大小為12
Each printed on an one page A4-sized paper with font size 12
 - ▶ 提供參賽作品的名稱
Include the Entry Title

遞交參賽作品（續） Entry Submission (cont.)

裱貼板的排列 Arrangement of the Panels :

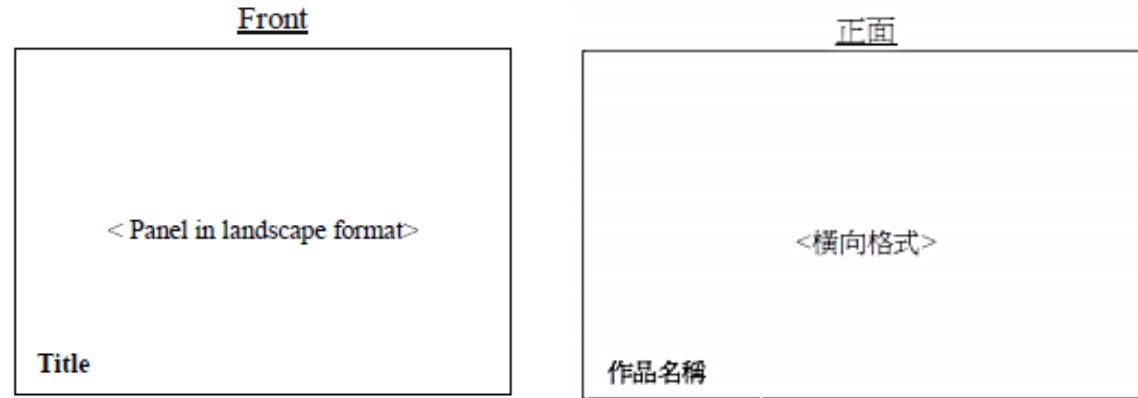

- ▶ 參賽作品可以直向或橫向格式排列
Entries can be in either portrait or landscape format
- ▶ 必須在每張裱貼板正面左下角位置，提供參賽作品的名稱
A title for each Entry shall be provided and annotated on the lower left corner of the front of each panel
- ▶ 必須將已填妥的參賽表格 B 部分貼在光碟上 (CD/DVD)
Completed Part B of the Entry Form shall be affixed to the CD/DVD disc

比賽組別 Entry Group

比賽只設一個組別，並公開予 There is only one entry group open to:

- ▶ 就讀相關學科的大專院校學生，包括：

Tertiary students in the relevant fields including:

- ❖ 工程、城市規劃、建築、園境建築、測量及城市設計

Engineering, Town Planning, Architecture, Landscape Architecture, Surveying, and Urban Design

- ▶ 來自以下專業學會的學生會員及畢業生會員：

Student members and graduate members of the following professional institutes:

- ❖ 香港工程師學會、香港規劃師學會、香港建築師學會、香港園境師學會、香港測量師學會及香港城市設計學會；或

The Hong Kong Institution of Engineers (HKIE), The Hong Kong Institute of Planners (HKIP), The Hong Kong Institute of Architects (HKIA), The Hong Kong Institute of Landscape Architects (HKILA), The Hong Kong Institute of Surveyors (HKIS), and The Hong Kong Institute of Urban Design (HKIUD); or

- ▶ 來自以下專業學會的青年會員：

Young members of the following professional institutes:

- ❖ 香港工程師學會青年會員事務委員會、香港規劃師學會青年規劃師組、香港建築師學會青年會員事務委員會、香港園境師學會園境師青年組、香港測量師學會青年組及香港城市設計學會青年組

Young Members Committee of HKIE, Young Planners Group of HKIP, Young Members Committee of HKIA, Young Landscape Architects' Group of HKILA, Young Surveyors Group of HKIS and Young Urban Design Professionals of HKIUD

比賽組別 (續) Entry Group (cont.)

- ▶ 比賽不接受以公司 / 機構 / 組織名義參加
Entries by any company/organisation/institution will not be accepted
- ▶ 參賽者可以小組合作形式參賽，惟隊員需於參賽表格內提名一位隊長，而所有小組合作的參賽隊員都必須以個人身份參與
Team entries are permitted and members shall nominate a leading member in the Entry Form while members of a Team Entry must be individuals
- ▶ 個人及小組參賽者的參加次數不限，小組成員的人數亦無限制
There is no limitation on the number of Entries an individual or a Team may submit and there is no limitation to the number of members to a Team
- ▶ 每份參賽作品須同時附上一份已填妥的參賽表格
Each Entry must be accompanied with its own fully completed Entry Form

評審委員會 Panel of Judges

葉傲冬先生, JP Mr IP Ngo-tung, Chris, JP	油尖旺區議會主席 Chairman, Yau Tsim Mong District Council
陳國璋工程師 Ir Thomas K.C. CHAN	香港工程師學會會長 President, The Hong Kong Institution of Engineers (HKIE)
陳沐文先生 Mr Marvin CHEN	香港建築師學會會長 President, The Hong Kong Institute of Architects (HKIA)
杜立基先生 Mr Kenneth L.K. TO	香港規劃師學會副會長 Vice-President, Hong Kong Institute of Planners (HKIP)
黃德業先生 Mr Tak WONG	香港園境師學會會長 President, The Hong Kong Institute of Landscape Architects (HKILA)
郭岳忠測量師 Sr KWOK Ngok Chung, Dick	香港測量師學會會長 President, The Hong Kong Institute of Surveyors (HKIS)
鄧文彬教授, BBS Prof. Stephen TANG, BBS	香港城市設計學會會長 President, Hong Kong Institute of Urban Design (HKIUD)

註：主辦機構有權更改評審委員會的組成，而不作另行通知。評審委員會的最終名單將於比賽網頁公佈。

Note: The Organiser reserves the right to make any changes to the composition of the Panel of Judges without prior notice. Final list of the Panel of Judges will be announced at Competition webpage.

評審準則 Assessment Principles

評審準則 Assessment Criteria	比例 Percentage
創意及創新 Creativity and innovation	20%
設計、美感及地區特色的應用 Design, aesthetics, and adoption of local characters	20%
可持續發展及環保概念 Sustainability and environmental implications	20%
與周邊現有和已規劃發展的兼容性 Compatibility with existing and planned developments in the neighbourhood	15%
功能及實用性 Functionality and practicability	15%
表達技巧 Quality of presentation	10%

結果與獎項 Results and Prizes

勝出作品 (3 份) Three Winning Entries

冠軍 First Prize: HK\$15,000

亞軍 Second Prize: HK\$10,000

季軍 Third Prize: HK\$8,000

優異作品 (2 份) Two Entries of Merit

各獲面值港幣 1,000 元的書券

HK\$1,000 book coupon each

THANK YOU

聯絡人 **Contact Persons**

姓名 Name: 柳淑芝女士 Ms. Bonnie LAU

電話 Tel: 3917-4909

電郵 Email: bonlau@hku.hk

林組懿女士 Ms. Joyee LAM

3917-8638

joyeelam@hku.hk